

- SEE A6 FOR WALL SCHEDULE
- SEE A9 FOR DOOR SCHEDULE
- SEE A10 FOR WINDOW & FINISH SCHEDULES
- SEE STEEL BUILDING DRAWINGS FOR ALL OPENING LOCATIONS

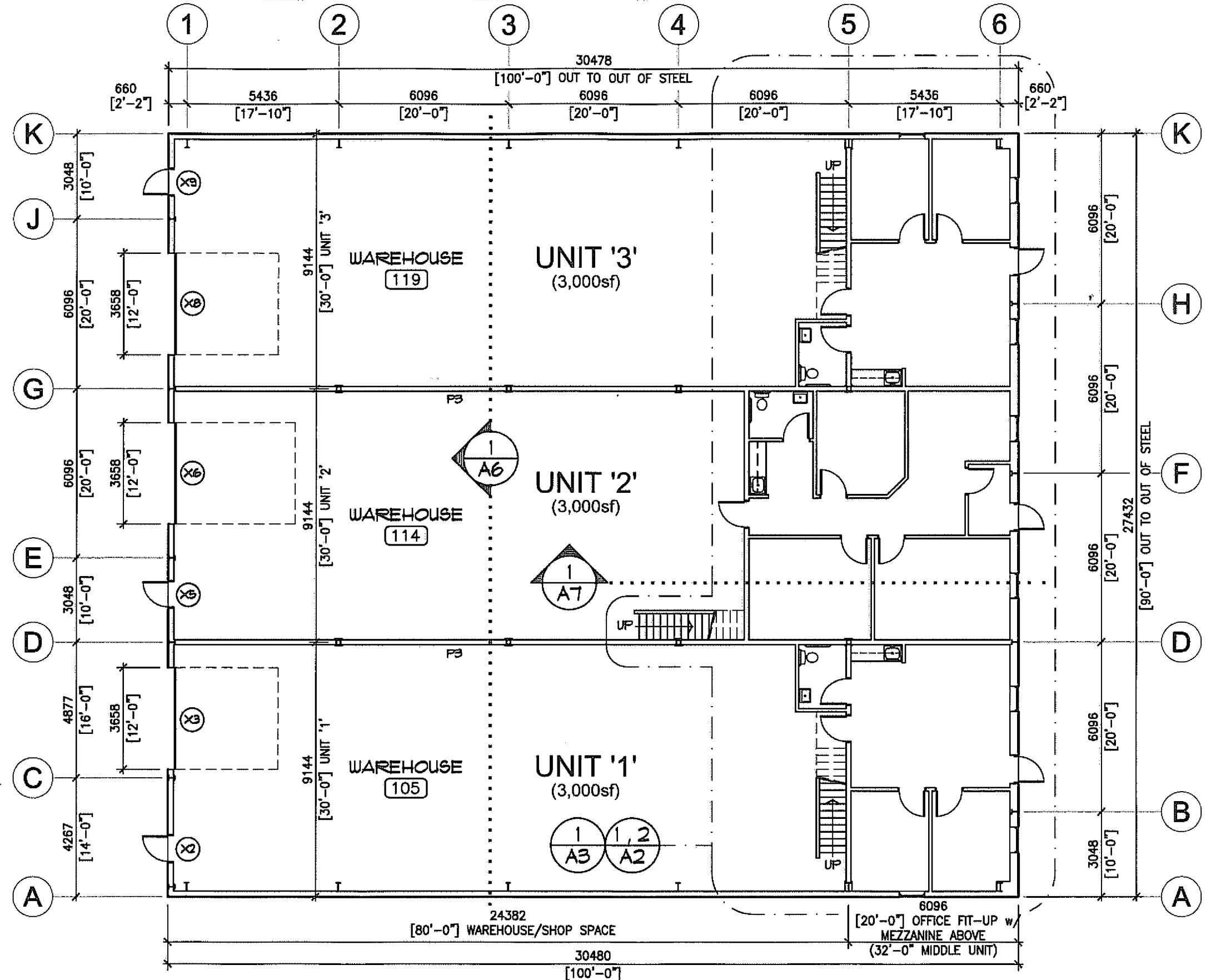

9 Allston Street
 Mt. Pearl, NL, A1N 0A3
 Tel: (709) 747-4234
 Fax: (709) 747-4441

Project
**PROPOSED
 COMMERCIAL CONDO BUILDING
 PARADISE, NL**

Title
MAIN FLOOR PLAN

Drawn
BD
 Job #
 --

Checked
A. Butt
 Scale
1 : 150

Date
APRIL 2009
 Sheet
A1 of 10
 Rev.
1